

SPS fibre FORM Instrument Protection Enclosure Type FF224

Dimensions: (Approx.) Height x Width x Depth
20 1/2"(521mm)x17 1/2"(445mm)x16 5/8"(422mm)

Weights: (Approx.)

Un-Insulated 22 lbs. / 10 kgs.

Insulated 25 lbs. / 11 kgs.

SPS fibre FORM enclosures are "Resin Transfer Molded" with glass reinforced epoxy vinyl ester resin. The outer surface standard is light gray colored "Gel-Coat" for ultimate "UV" protection. Stainless steel hinges and clasps combine with a self-skinned closed cell neoprene gasket to provide NEMA 4X protection.

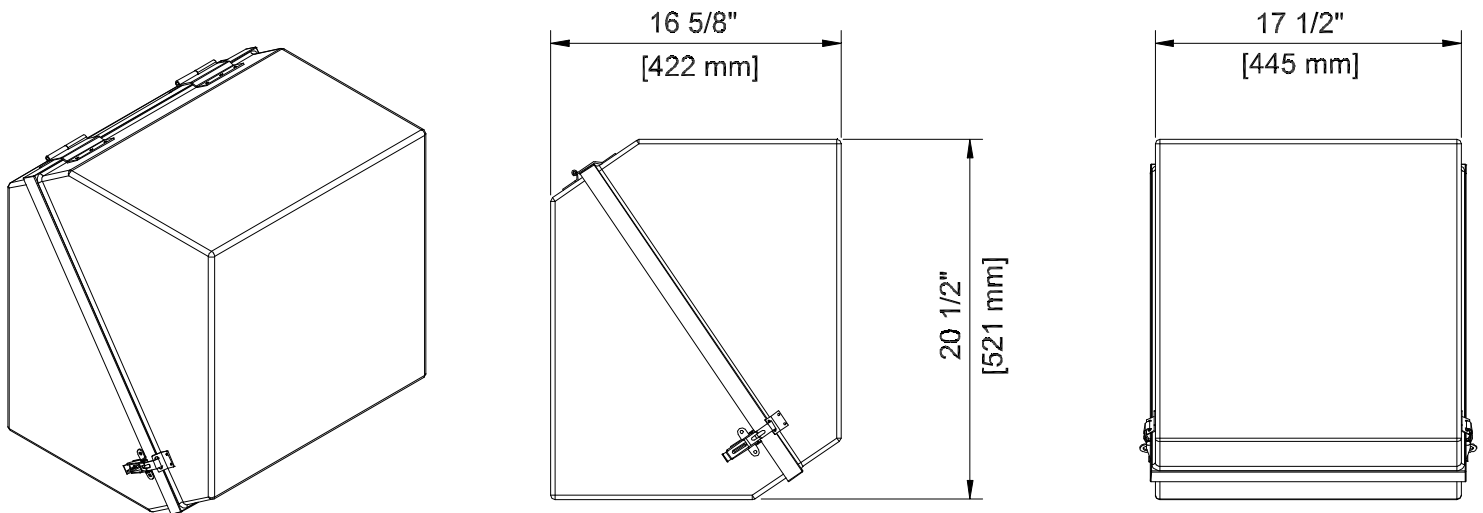

OPTIONS:

I-PUAL	- Extra Insulation (Aluminum Foil)	EMP	- External 2" Post Mount Hub
I-PUFR	- Extra Insulation (FRP coated)	GMP	- Galvanized Mounting Plate
I-PUSS	- Extra Insulation (Stainless Foil)	GWB	- Galvanized Wall Mount Bracket
LPS	- Stainless Lid Prop-Stay	RMS	- Internal Mounting Rail System
CMSS	- Stainless Steel Corner Mount	PW	- Plexi-Glass Window
CMCSP	- Plated Steel Corner Mount	SW	- Safety Glass Window
IMP	- Internal 2" Instrument Mount Post		